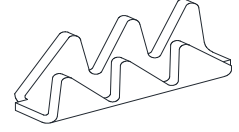

SPLICES WITH INSULATION BARREL**TK 2804****Description/Tanım**

MINİ İĞNE UÇ

Wire section range0,25 - 0,50 mm²

Kablo kesit aralığı

Materials & Temperature

Malzeme ve Sıcaklıkları

Part no	Material	Coating	Max. Temp. (°C)
TK 2804 RP	Brass / Pirinç	Naturel	110
TK 2804 RPK	Brass / Pirinç	Tin/Kalay	120
TK 2804 RÇN	Steel / Çelik	Nickel/Nikel	300

Note : Temperatures as per IEC 61210 standard.

Material thickness

0,30 mm

Malzeme kalınlığı

Crimping parameters & Pull-out force

Sıkma parametreleri ve Çekme kuvveti

Wire section (mm ² ±10%) Kablo kesiti	Conductor (±0.03) iletken		Pull-out force (N) Çıkma kuvveti
	Height/Yüks.(mm)	Width/Gen.(mm)	
0,25	1,2	1,67	>60
0,50	1,3	1,74	>100

Note : Values only valid for the application tool specified upwards. The insulator widths are only indicative as they are dependent on the sheath thickness of the wire used

Packaging

Ambalaj

25.000 pcs / Wide cardboard reel.

Pitch

Hatve

30,5 mm

Drawing

Çizim

Approvals

Onaylar

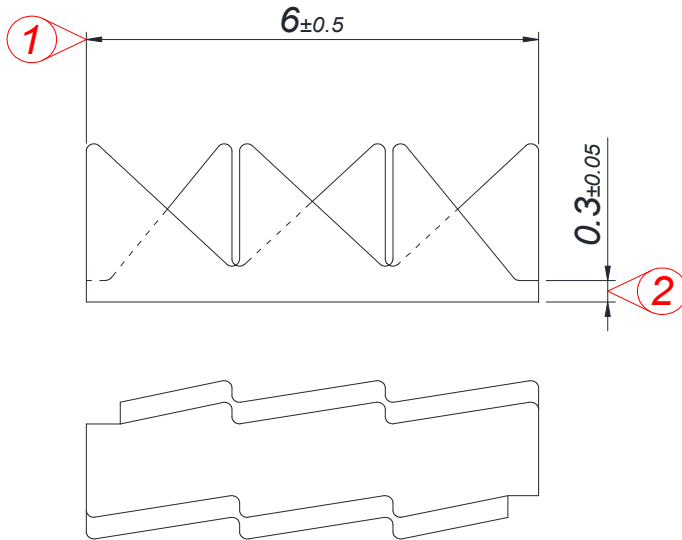
- RoHS Compliant
- REACH

Rev. No	Revision/Revizyon
00	
01	