

SEM-S1

EUROPE TYPE BUTT CONNECTORS

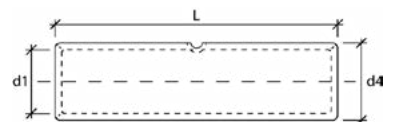

Order Code	Cable Section (mm ²)	Dimensions			Box Pcs.	Box Weight	Parcel Pcs.	Box Weight
		d1	d4	L				
SEM-S1/002.5	2.5	2,3	4,2	25,0	700	~1,4 kg.	4200	~8,4 kg.
SEM-S1/004	4	3,0	5,0	25,0	600	~1,6 kg.	3600	~9,6 kg.
SEM-S1/006	6	3,5	6,5	25,0	600	~3,0 kg.	3600	~18,0 kg.
SEM-S1/010	10	4,5	7,0	30,0	400	~2,9 kg.	2400	~17,4 kg.
SEM-S1/016	16	5,5	8,5	35,0	300	~3,0 kg.	1800	~18,0 kg.
SEM-S1/025	25	7,0	10,0	40,0	200	~2,8 kg.	1200	~16,8 kg.
SEM-S1/035	35	8,5	12,0	45,0	125	~2,8 kg.	750	~16,8 kg.
SEM-S1/050	50	10,0	14,0	50,0	70	~2,4 kg.	420	~14,4 kg.
SEM-S1/070	70	12,0	16,5	55,0	60	~2,9 kg.	360	~17,4 kg.
SEM-S1/095	95	13,5	18,0	60,0	50	~3,0 kg.	300	~18,0 kg.
SEM-S1/120	120	15,0	19,5	65,0	40	~2,8 kg.	240	~16,8 kg.
SEM-S1/150	150	16,5	21,0	70,0	20	~1,6 kg.	120	~9,6 kg.
SEM-S1/185	185	19,0	24,0	75,0	20	~2,0 kg.	120	~12,0 kg.
SEM-S1/240	240	21,0	26,0	85,0	15	~2,1 kg.	90	~12,6 kg.
SEM-S1/300	300	23,5	29,5	100,0	10	~2,2 kg.	60	~13,2 kg.
SEM-S1/400	400	27,0	34,0	100,0	5	~1,5 kg.	30	~9,0 kg.

SEM-S1 SPECIFICATIONS

MATERIAL	ELECTROLYTIC COPPER CONFORMED TO EN 13800
COATING	TIN PLATED
JOINT	CLAMP COUPLING
THICKNESS	VERY THICK

